

### ■ Features

1. ISO 1, ISO 2 solenoid valve.
2. Aluminum alloy body.
3. With single sub base and manifold sub-base which are identical to ISO 1 & ISO 2 standard.
4. Coil nut is available, please refer to page 5-1.



### ■ How to order

PS520 X	F	-	O2	N	-	S	2	L	E1
<b>520:</b> 5/2 Way	<b>Blank:</b> Standard	<b>Blank:</b> W/O base	<b>02:</b> ISO 1	<b>Blank:</b> G	<b>S:</b> Single solenoid	<b>1:</b> 110VAC	<b>Blank:</b> W/O LED	<b>Blank:</b> DIN	
<b>530:</b> 5/3 Way	<b>5/3 Way</b> <b>Blank:</b> Closed center <b>X:</b> Exhaust center <b>Y:</b> Pressurized center	<b>F:</b> W/I single sub-base <b>M02:</b> 2 Valves stack <b>M03:</b> 3 Valves stack <b>Mxx:</b> xx Valves stack	<b>03:</b> ISO 2 <b>04:</b> ISO 2	<b>N:</b> NPT <b>R:</b> Rc	<b>D:</b> Double solenoid	<b>2:</b> 220VAC <b>6:</b> 24VAC <b>7:</b> 12VDC <b>9:</b> 24VDC	<b>L:</b> W/I LED	<b>F:</b> Lead wire <b>E1:</b> EX-proof 22mm width <b>E2:</b> EX-proof 30mm width <b>E3:</b> EX-proof CSA standard	

### ■ How to order manifold

ZESF - O2	ZEPS520B - O2	ZEPS520E - O2
Single sub-base	Manifold sub-base	End plate
Port size	Port size	Port size
02 : 1/4" (ISO 1) 03 : 3/8" (ISO 2) 04 : 1/2" (ISO 2)	02 : 1/4" (ISO 1) 03 : 3/8" (ISO 2)	02 : 3/8" (ISO 1) 03 : 1/2" (ISO 2)

### ■ Specifications

Model	PS520-02-S	PS520-02-D	PS530-02-D	PS520-03-S	PS520-03-D	PS530-03-D
Port size	1/4"			3/8" (1/2")		
Body material	Aluminum alloy					
Effective area	29mm <sup>2</sup>	24mm <sup>2</sup>	62mm <sup>2</sup>	57mm <sup>2</sup>		
Fluid	Compressed air					
Acting	Internal pilot					
Operating pressure range	1.5 ~ 8 kgf/cm <sup>2</sup>					
Proof pressure	9.9 kgf/cm <sup>2</sup>					
Ambient temperature	-10°C ~ 60°C					
Duty cycle	100% ED					
Coil type	DIN					
Protection class	IP65 (DIN 40 050)					
Insulation class	F					
Voltage tolerance	±10%					
Standard voltage	220VAC, 110VAC, 24VDC (The other voltage is optional)					
Net weight (W/I base)	320g (500g)	460g (640g)	500g (680g)	700g (980g)	840g(1120g)	910g(1190g)

### ■ Dimensions

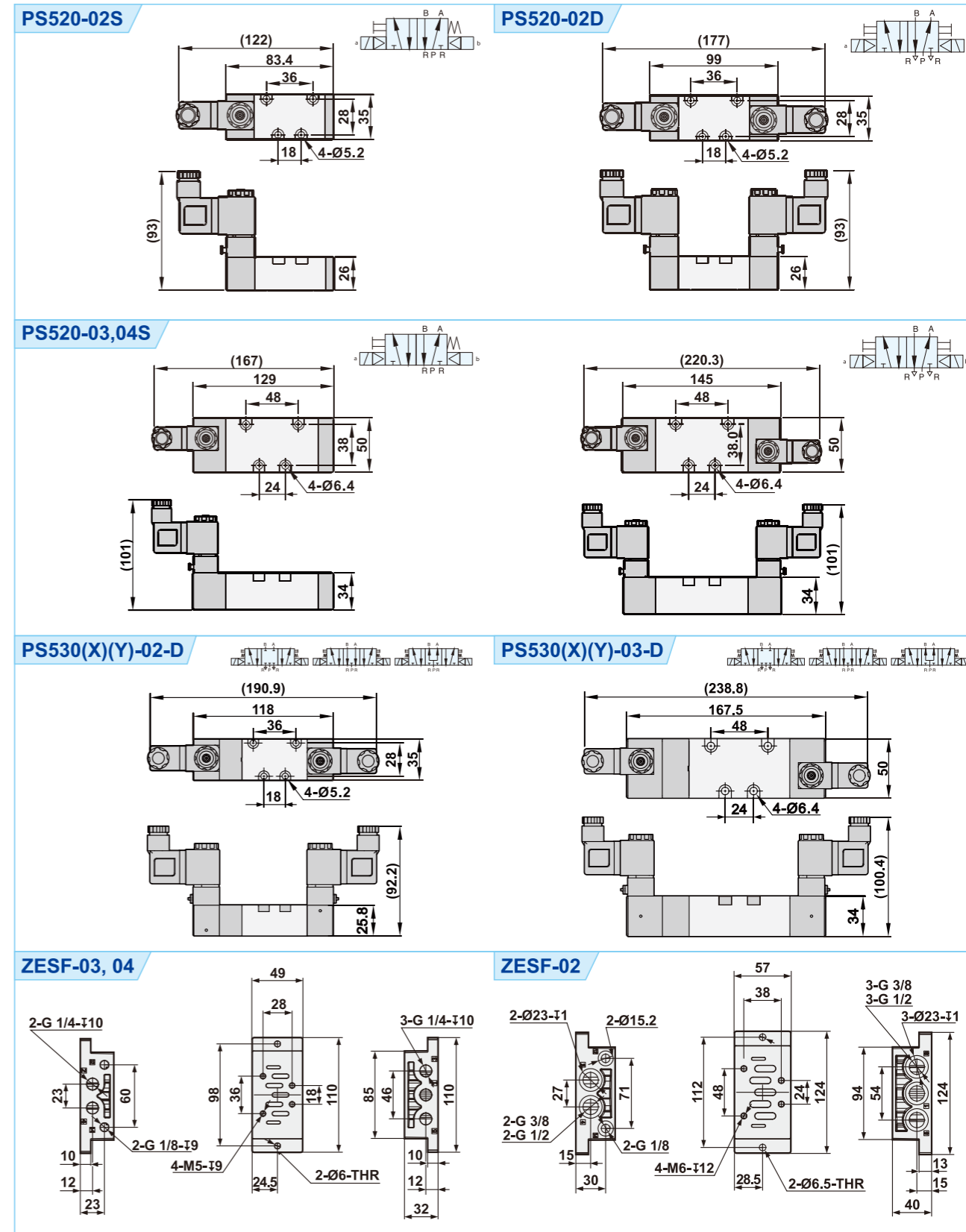

■ Dimensions

ZEPS520B-02 (ISO1 Manifold sub-base)

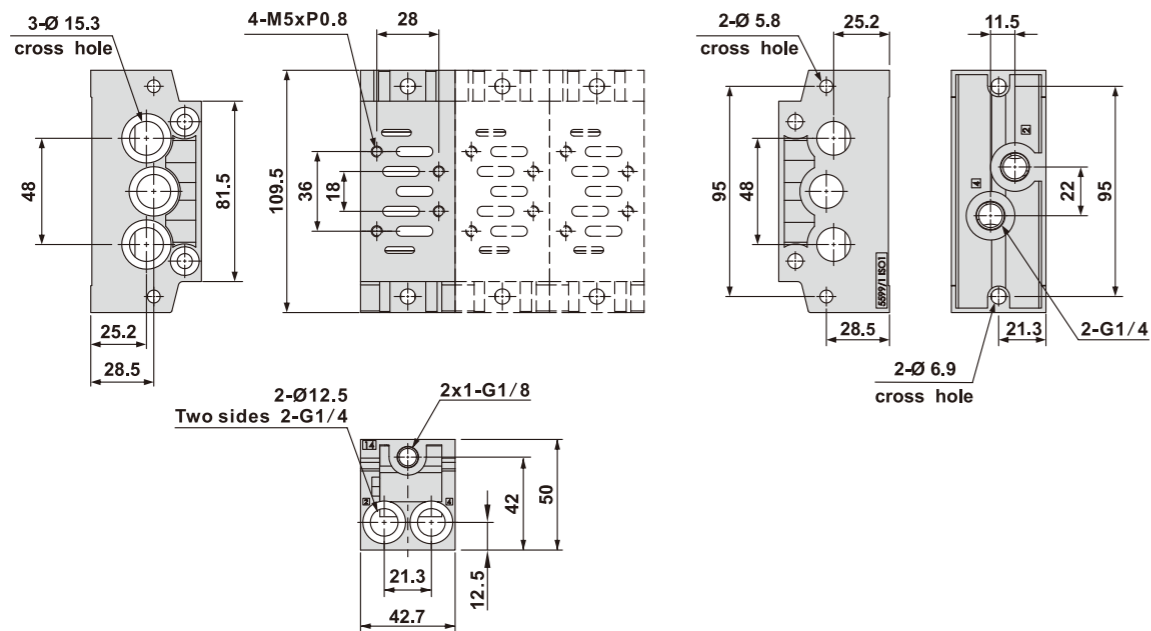

ZEPS520B-03 (ISO2 Manifold sub-base)

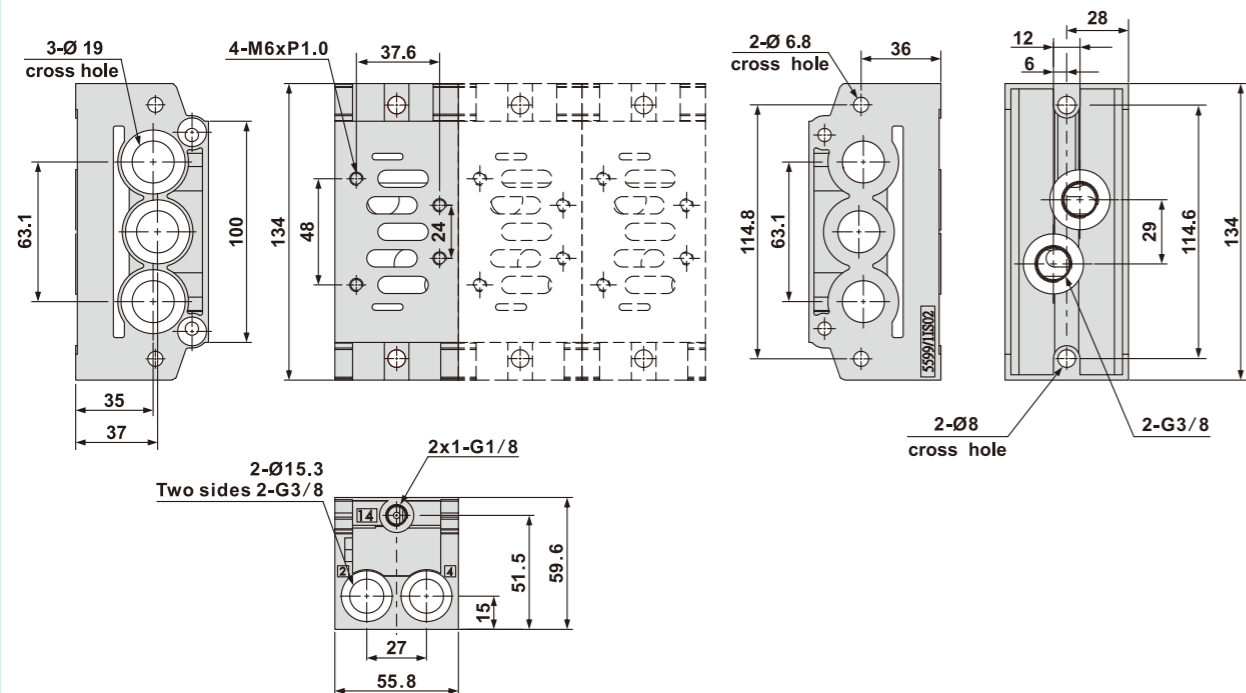

■ Dimensions

ZEPS520E-02 (ISO1 End plate)

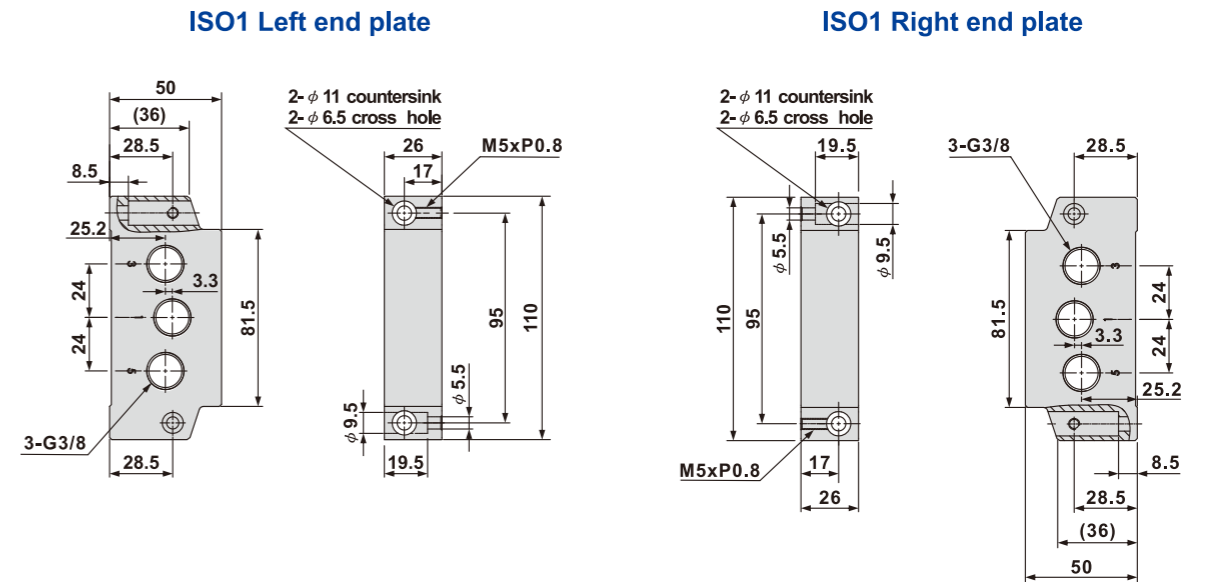

ZEPS520E-03 (ISO2 End plate)

