

# Quick Exhaust Valve

## Symbol

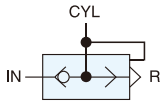

## Features

1. Increase piston speed instantly.
2. The valve is able to install on cylinder ports.



## How to order

Q	-	01	N
Quick Exhaust Valve		Port size	Thread
		01: 1/8"    04: 1/2" 02: 1/4"    06: 3/4" 03: 3/8"	Blank: G N : NPT R : Rc

## Specifications

Model	Q-01	Q-02	Q-03	Q-04	Q-06
Port size	1/8"	1/4"	3/8"	1/2"	3/4"
Body material	Aluminum alloy				
Fluid	Compressed air				
Sectional area	16mm <sup>2</sup>	27mm <sup>2</sup>	28mm <sup>2</sup>	71mm <sup>2</sup>	72.5mm <sup>2</sup>
Operating pressure range	0.5 ~ 9.9 kgf/cm <sup>2</sup>				
Proof pressure	10 kgf/cm <sup>2</sup>				
Max. flow rate (l/min)	886	1823	2300	3000	3848
Ambient temperature	-10°C ~ 80°C				

## Dimensions

### Q-01~06

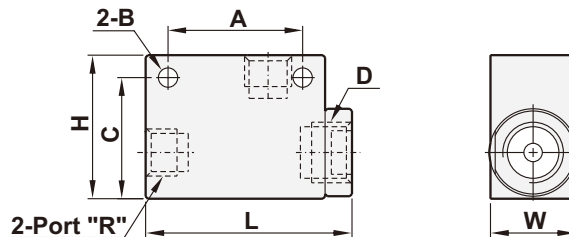

Model	R	L	W	H	A	B	C	D
Q-01	1/8"	46	19	32	30	φ 4.3	27	G 1/4
Q-02	1/4"	61.5	25.4	38	39	φ 5.6	31.5	G 3/8
Q-03	3/8"	61.5	25.4	38	39	φ 5.6	31.5	G 3/8
Q-04	1/2"	98	38	63.7	60	φ 8.5	50.5	G 3/4
Q-06	3/4"	98	38	63.7	60	φ 8.5	50.5	G 3/4